

CARNAHAN · PROCTOR · CROSS, INC.

CONSULTING ENGINEERS · SURVEYORS · PLANNERS

6101 WEST ATLANTIC BOULEVARD, MARGATE, FLORIDA 33063  
PHONE: 954-972-3959 FAX: 954-972-4178

MAY 2002

990901B

JSH

# EVERGRENE PLAT TWO

A REPLAT OF A PORTION OF TRACT "A", "EVERGRENE" (P.B. 93, PGS. 117-119, P.B.C.R.)  
CITY OF PALM BEACH GARDENS, PALM BEACH COUNTY, FLORIDA

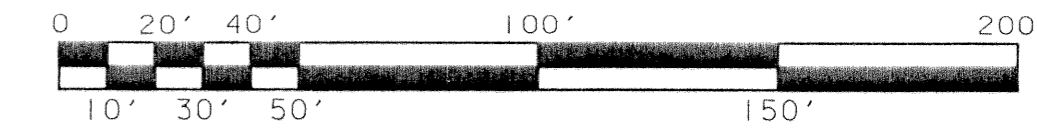
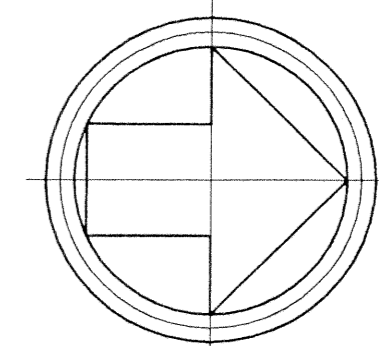

SCALE: 1"=40'

SHEET 6 OF 26

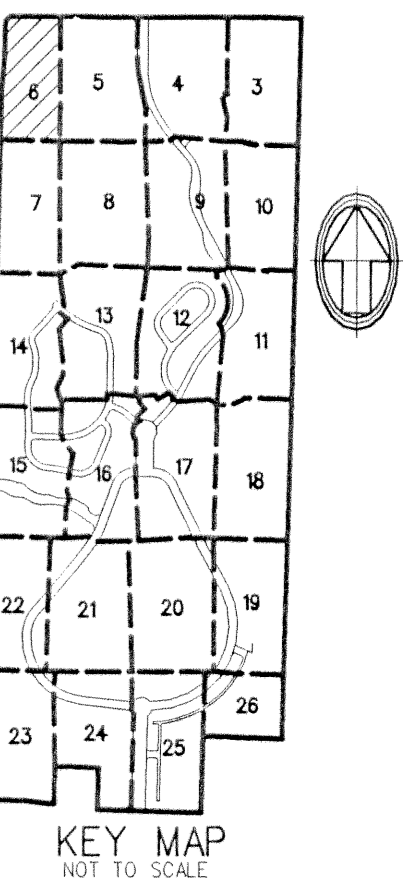

KEY MAP  
NOT TO SCALE

## MILITARY TRAIL

(O.R.B. 2353, PG. 1542)  
N01° 22'07"E 2618.49'  
WEST LINE E. 1/2 SECTION 25-41-42

FOUND BRASS DISC  
IN CONCRETE MONUMENT  
NORTH 1/4 CORNER  
SECTION 25-41-42

PLAT LIMITS

N01° 22'07"E 3240.22'  
1125 15' P.R.M. TO P.R.M.

TRACT B-7

N05° 01'52"E 250.50'

N01° 22'07"E 294.29'

N45° 45'28"E  
55.96'

S01° 22'07"W  
613.25'

S05° 01'52"W  
250.50'

S01° 22'07"W  
246.10'

TRACT C-3

N01° 22'07"E  
607.85'

N05° 01'52"E  
250.57'

N01° 22'07"E  
251.43'

22' PEDESTRIAN  
ACCESS EASEMENT

100.02'

S89° 51'14"E  
689.99'

685.97'

TRACT B-7

DONALD ROSS ROAD  
(O.B. 1031, PG. 628)  
S89° 51'14"E 2673.65'  
NORTH LINE SECTION 25-41-42

S89° 51'14"E 2430.53'

75'

TRACT F-8

### LEGEND:

- SET PERMANENT REFERENCE MONUMENT (P.R.M.) • LB2936 UNLESS OTHERWISE NOTED
- PERMANENT CONTROL POINT
- ⊕ CENTERLINE
- A ARC LENGTH
- A.E. ANCHOR EASEMENT
- CH CHORD
- CHB CHORD BEARING
- D DELTA (CENTRAL ANGLE)
- D.B. DEED BOOK
- D.E. DRAINAGE EASEMENT
- FPL FLORIDA POWER & LIGHT COMPANY
- IEE INGRESS EGRESS EASEMENT
- LSE LIFT STATION EASEMENT
- NPBCID NORTHERN PALM BEACH COUNTY IMPROVEMENT DISTRICT
- N.R. NON-RADIAL
- O.R.B. OFFICIAL RECORDS BOOK
- P.C.D. PLANNED COMMUNITY DEVELOPMENT
- PG. PAGE
- P.B. PLAT BOOK
- P.B.C.R. PALM BEACH COUNTY RECORDS
- R RADIUS
- R.P.B. ROAD PLAT BOOK
- R/W RIGHT-OF-WAY
- SF SQUARE FEET
- SLE SEWER LINE EASEMENT
- SUA SEACOAST UTILITY AUTHORITY
- U.E. UTILITY EASEMENT
- WMAE WATER MANAGEMENT ACCESS EASEMENT
- WME WATER MANAGEMENT EASEMENT
- WLE WATER LINE EASEMENT

MATCH LINE

SEE SHEET 5 OF 26

MATCH LINE  
SEE SHEET 7 OF 26

R=320.00' A=246.45'  
D=44° 07'35"

TRACT C-10

D=22° 15' 34"  
R=357.50' A=138.89'

M77° 08' 43"E  
25.13'

D=24° 07' 35"  
R=442.50' A=186.33'

N06° 58' 52"W  
31.95'

D=15° 42' 31"  
R=357.50' A=98.01'

N08° 43' 39"E  
37.60'

S89° 38' 21"E  
212.33'